

**P.D.1 VARIANTE DEL P.A.1**

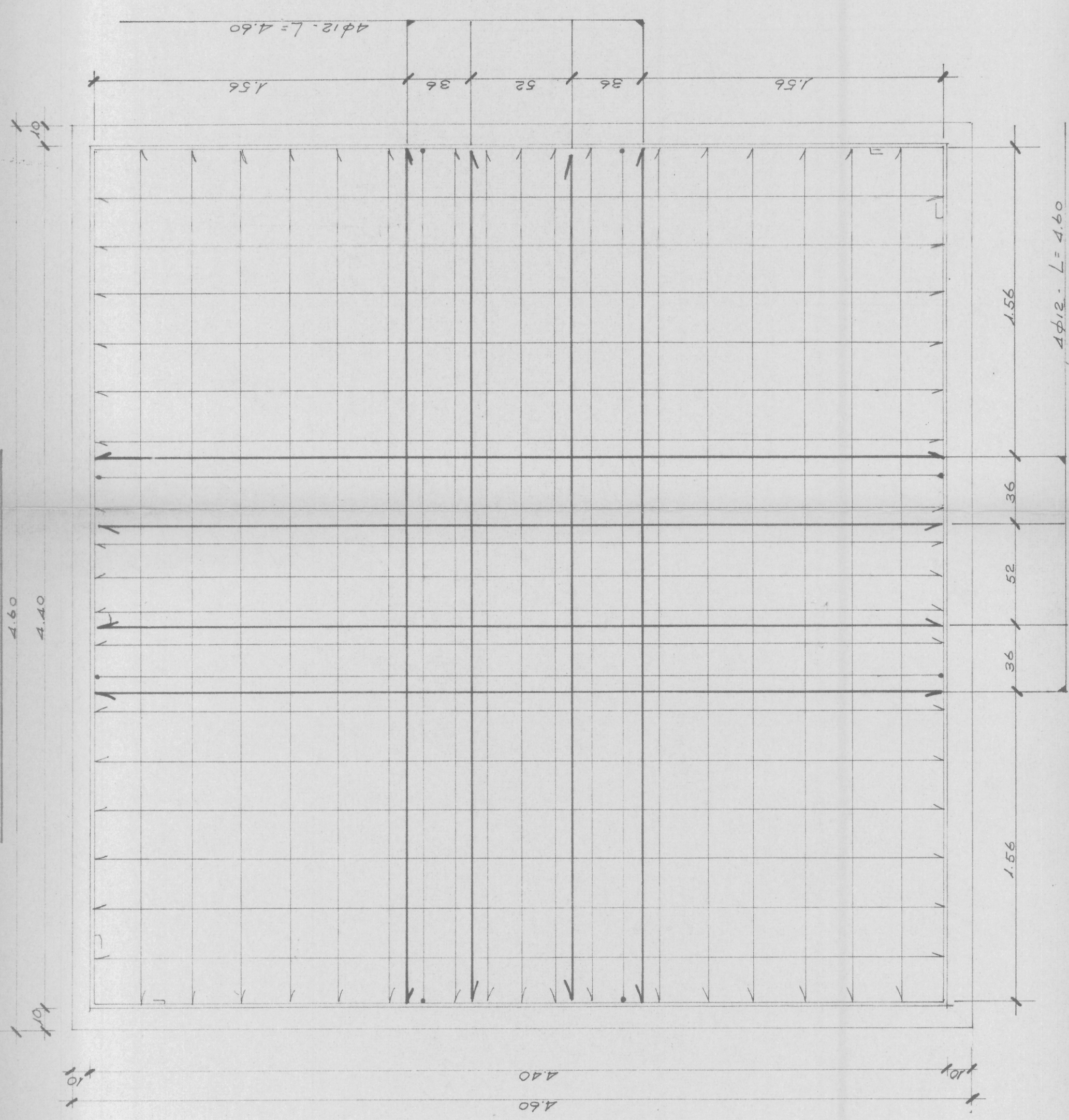

**P.D.2 VARIANTE DEL P.A.2**

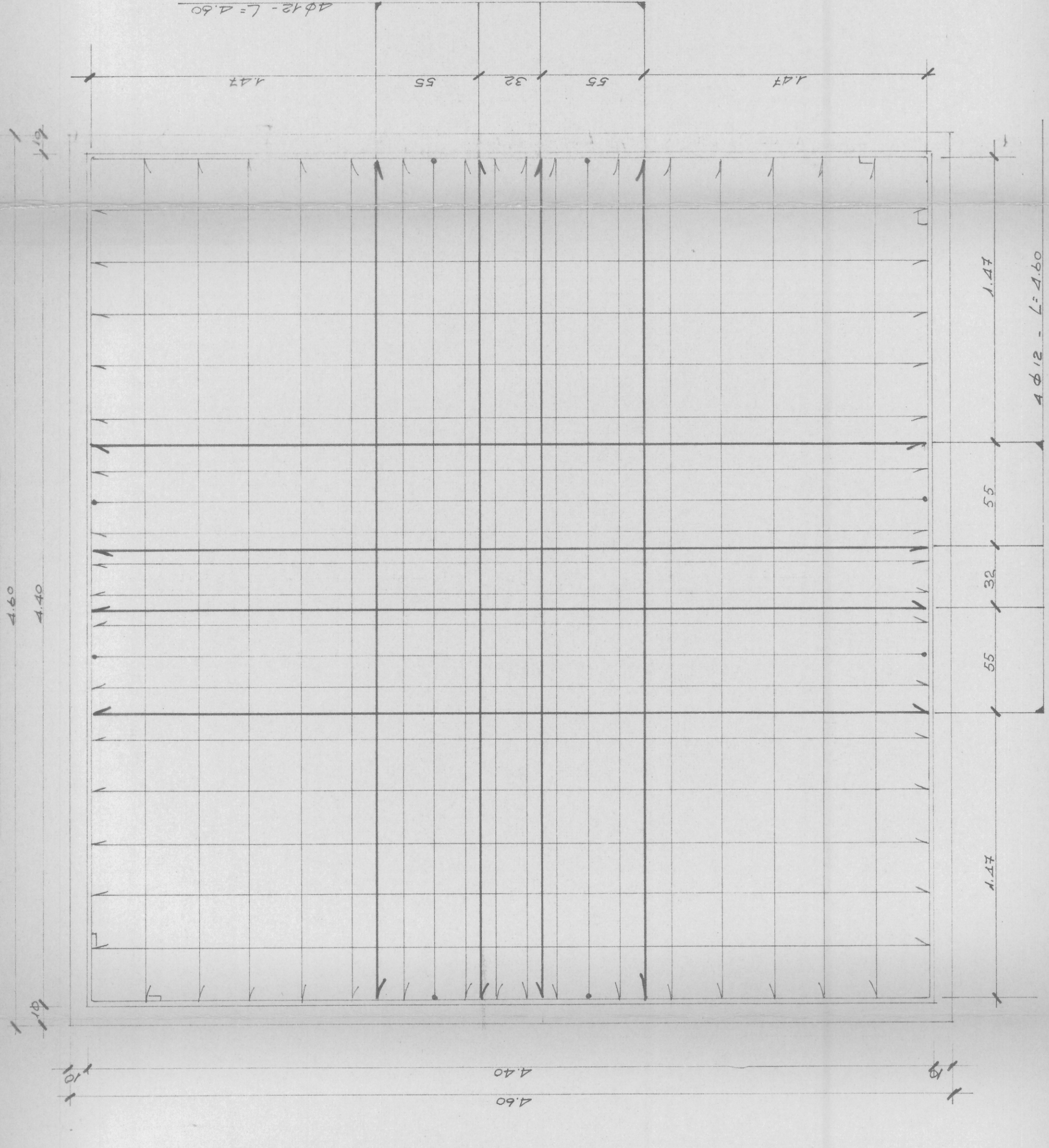

**PE.1 VARIANTE DEL PB.1**

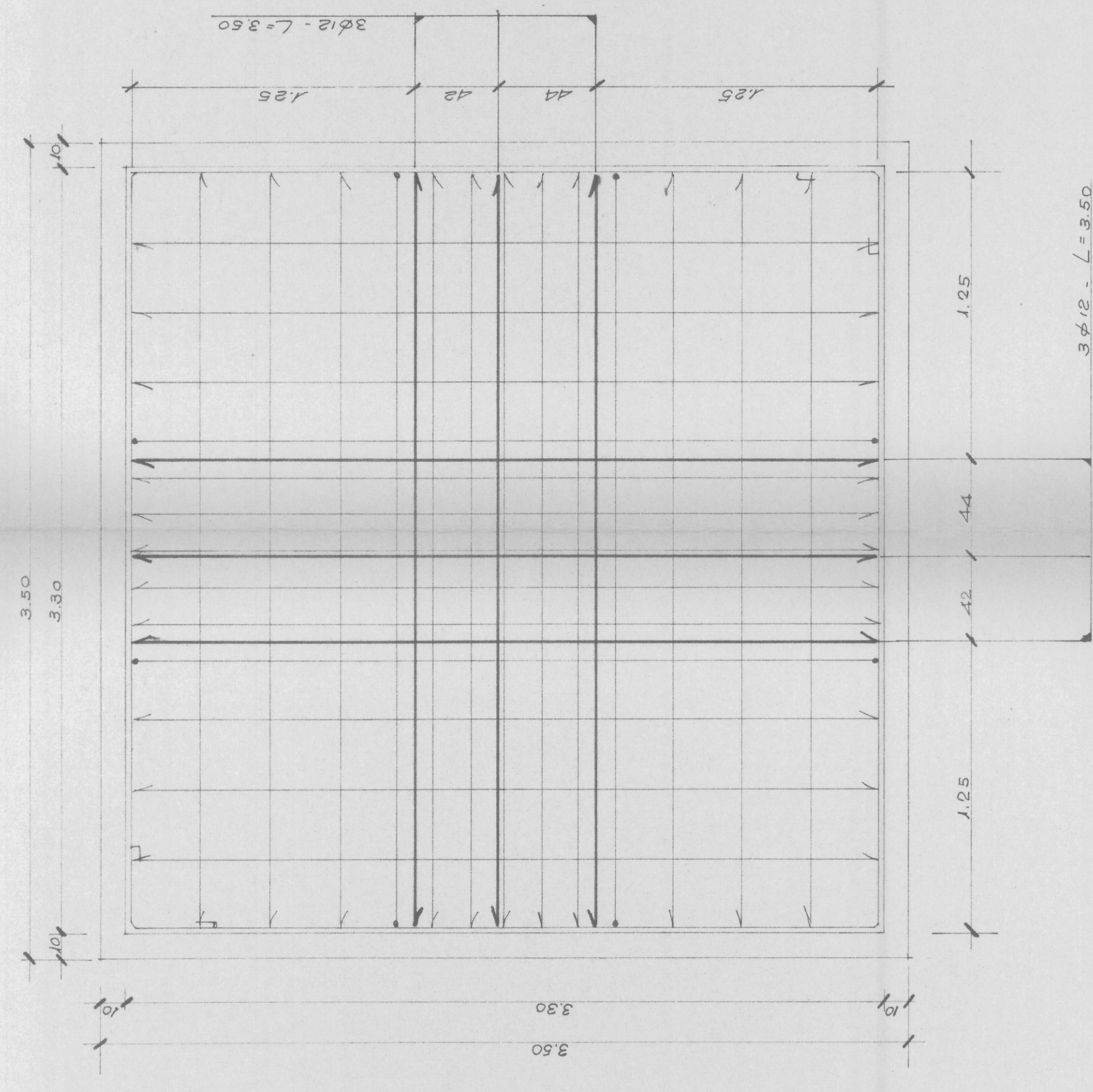

**PE.2 VARIANTE DEL P.B.2**

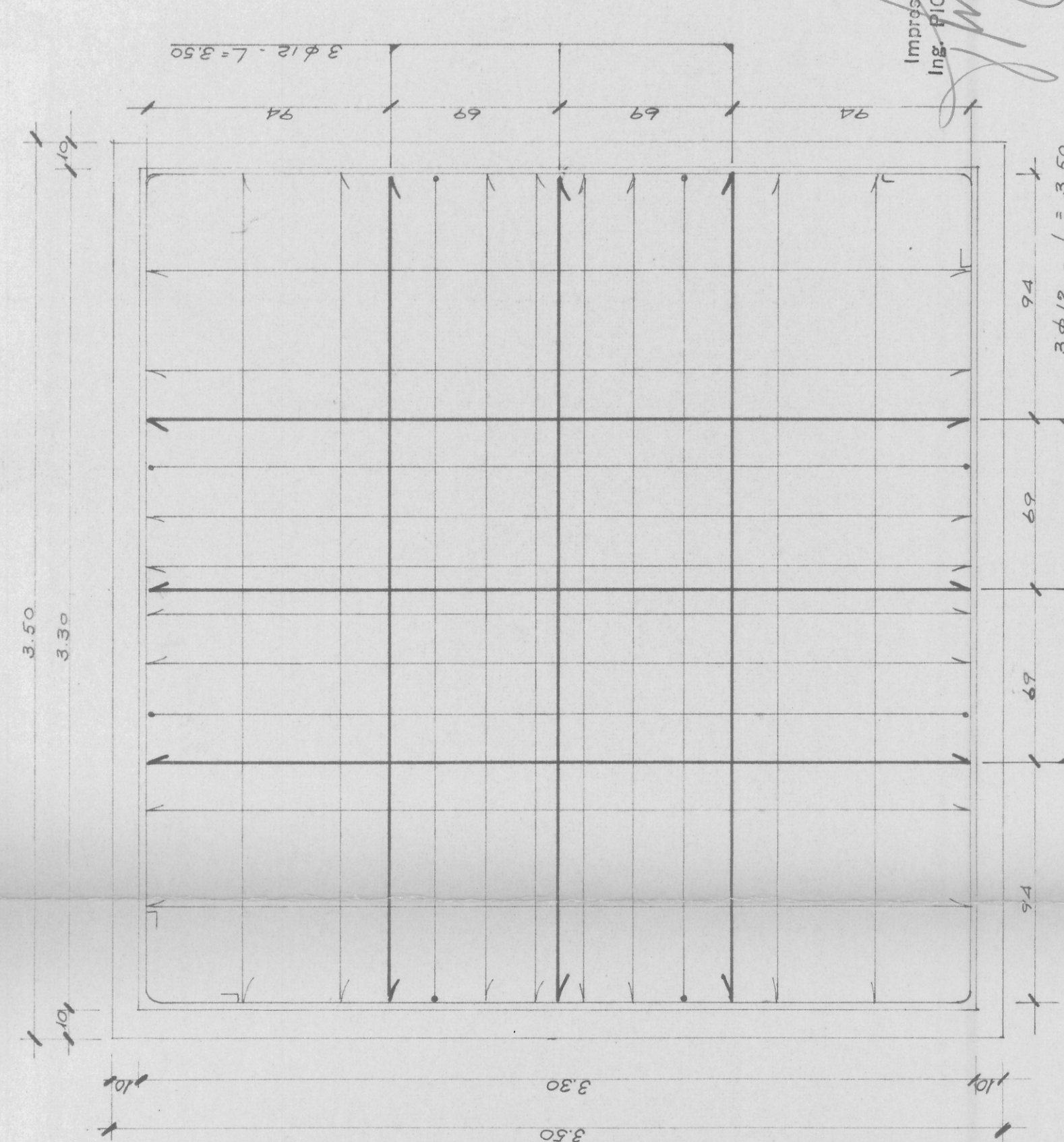

Impresa Costruzioni  
 Ing. PIO GUARALDO  
 strada castellana  
 paese - Iv - (tel. 47358)

ufficio tecnico impresa ing. **pio guaraldo**  
**140 PLINTI P.D.1, P.D.2, PE.1, PE.2**  
 scale 1:20  
 prog. dis. data 2/7/66

= armatura dei plinti PA e PB  
 = variante