

SE

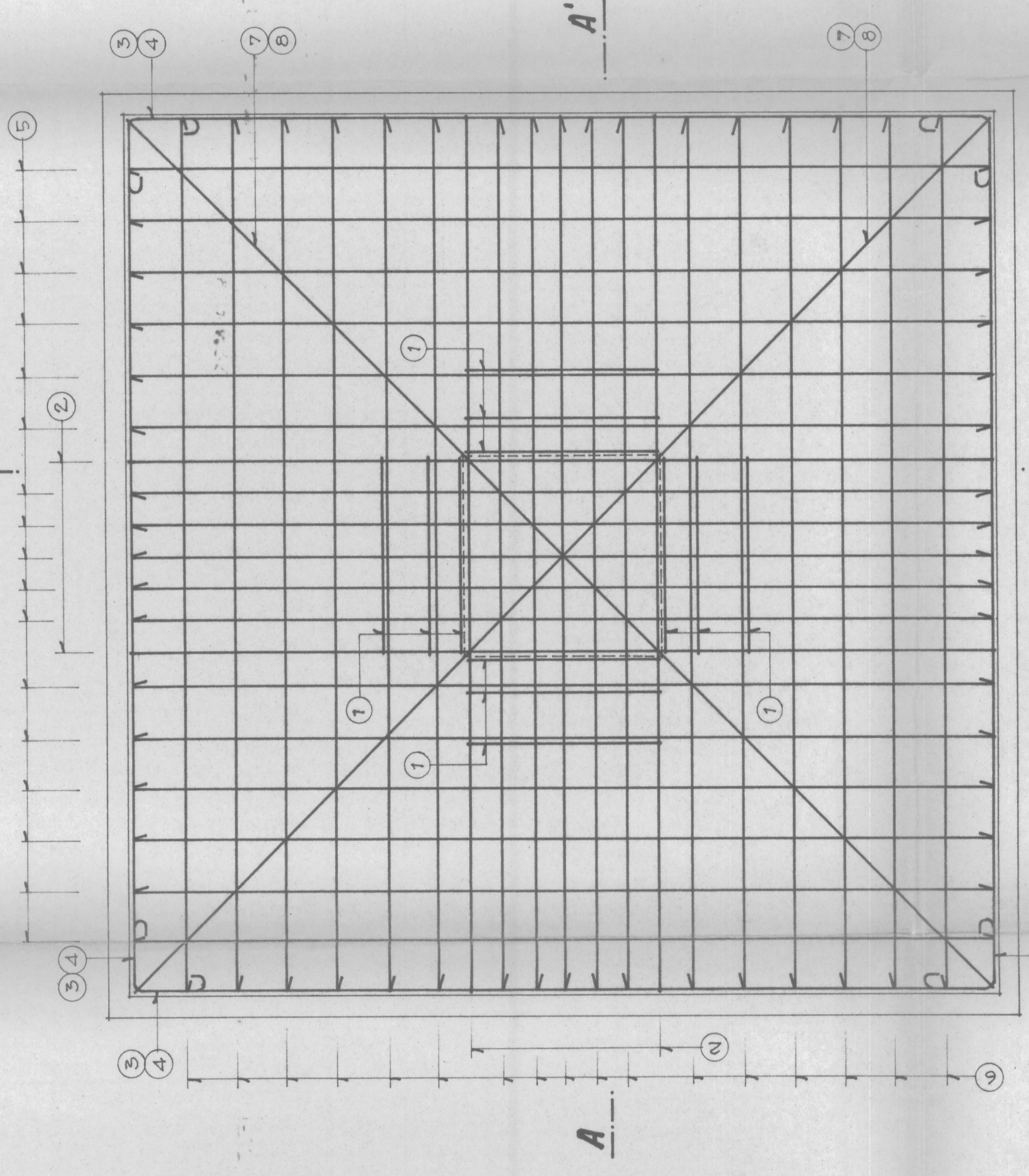

A-A'

B-B'

NO. PER I FERRI DI ARMATURA DEL BICCHIERE
VEDI DISegno N° 213

101

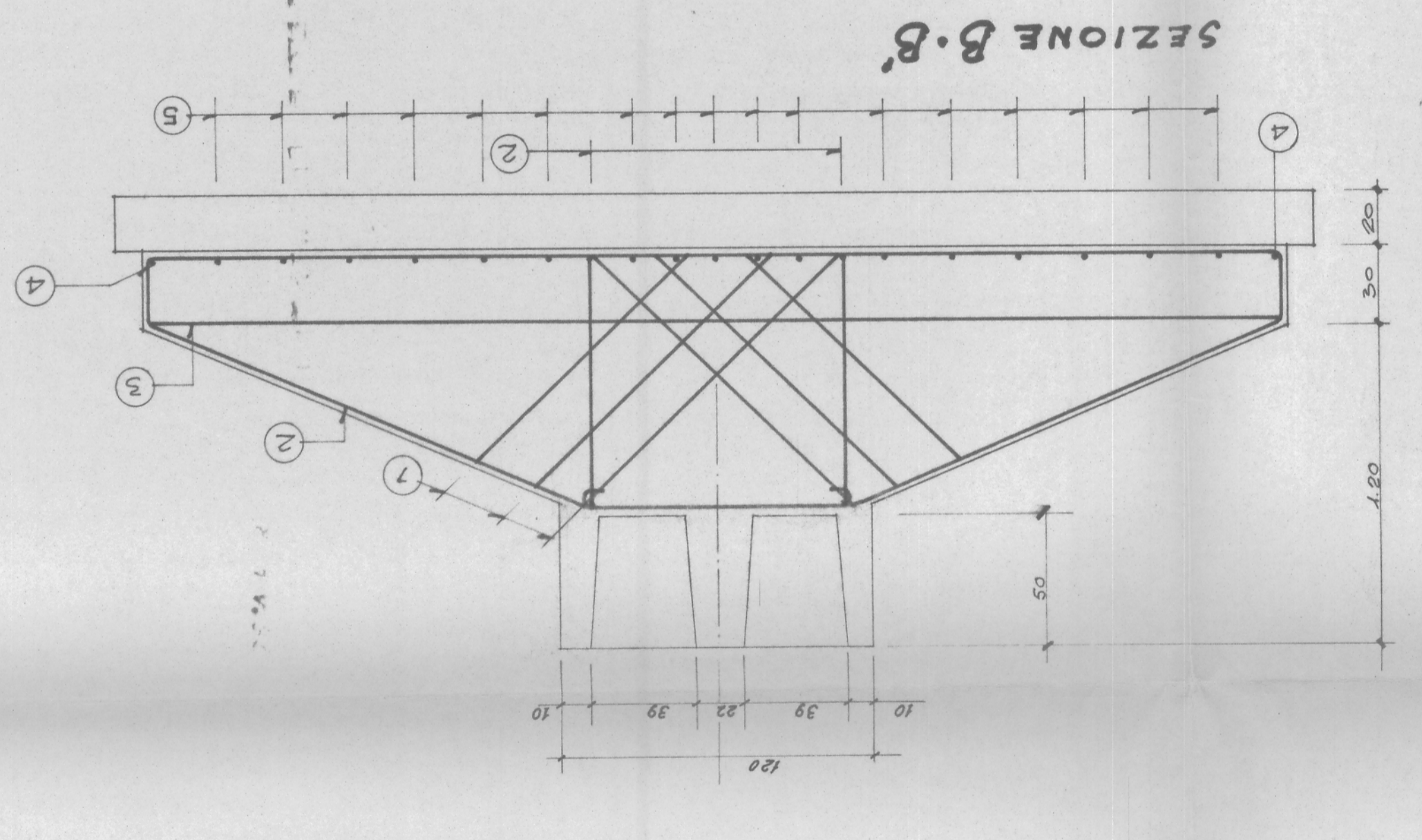

SEZIONE B-B'

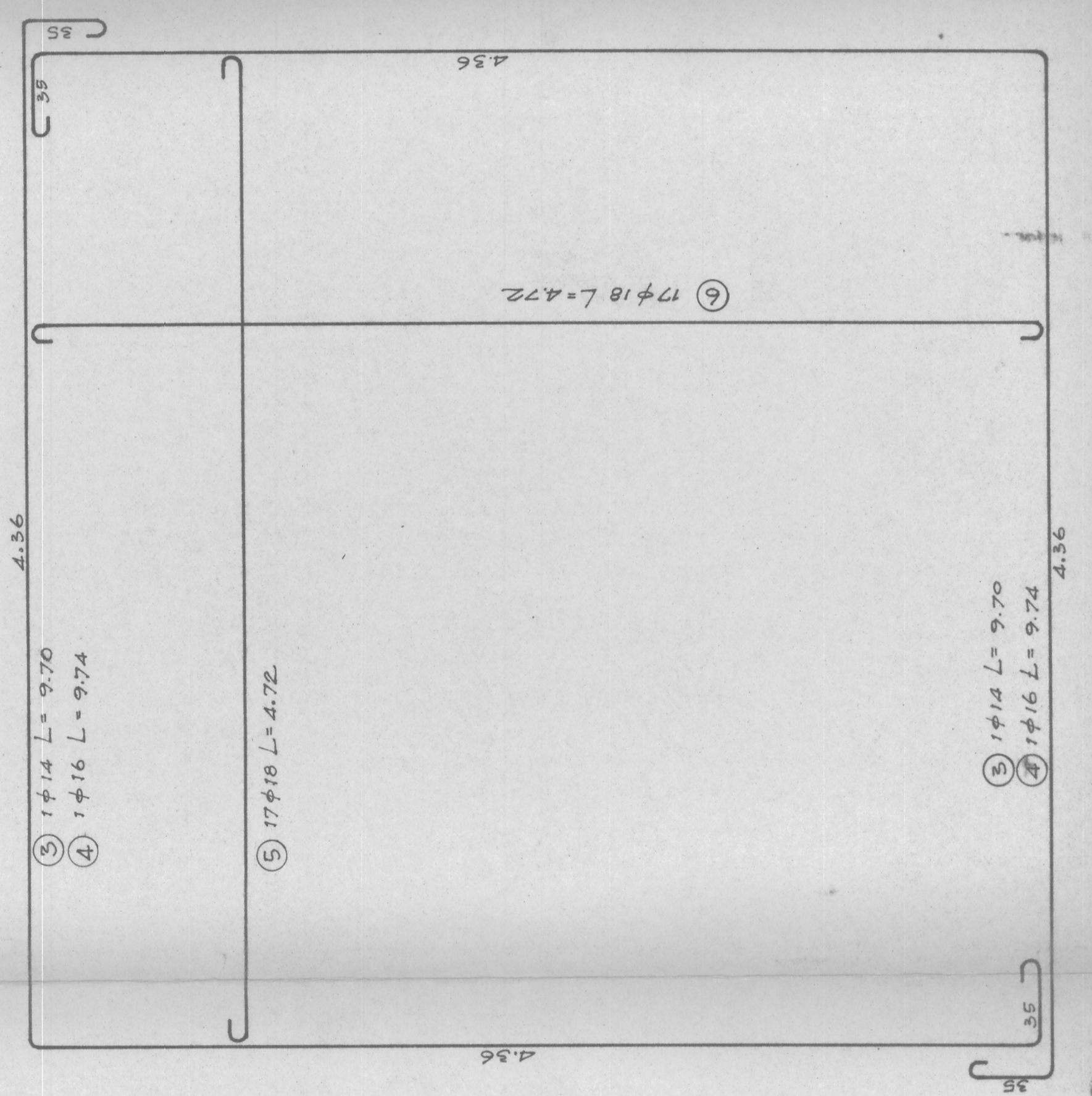

3) 1φ14 L=9.70
4) 1φ16 L=9.74
5) 17φ16 L=4.72

3) 1φ14 L=9.70
4) 1φ16 L=9.74

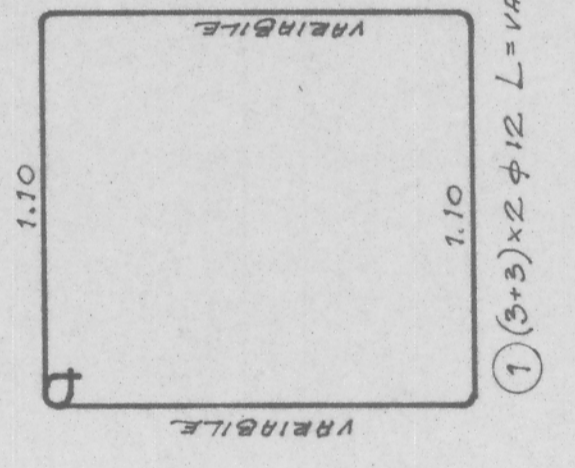

1) (3+3)x2 φ12 L=VARIABILE

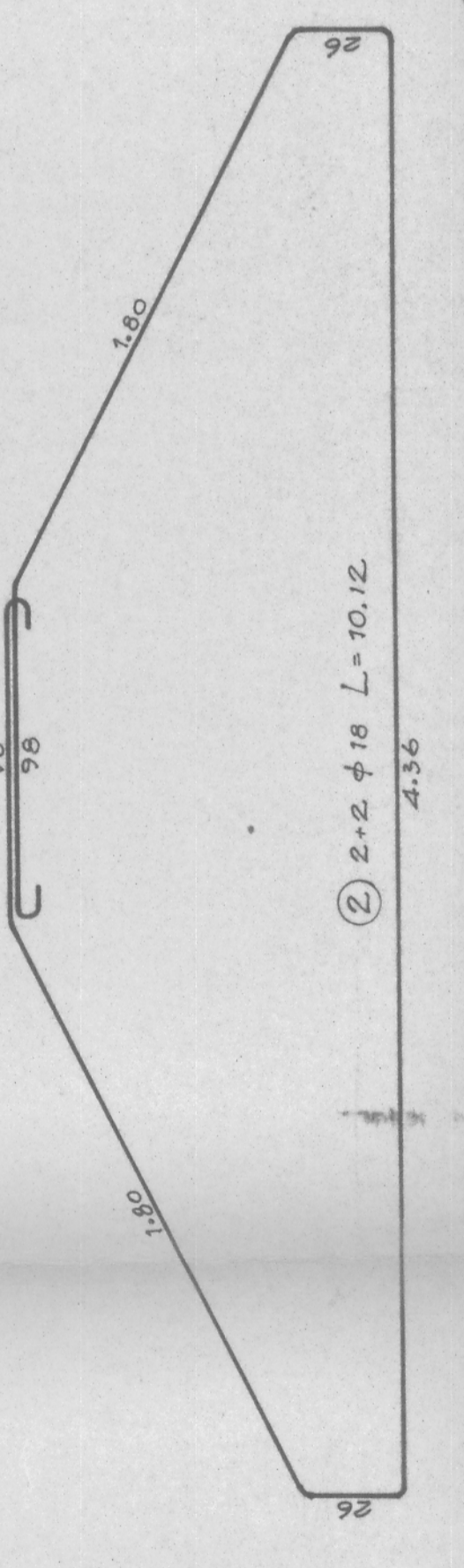

1) 2φ16 L=10.12
2) 2φ16 L=10.12

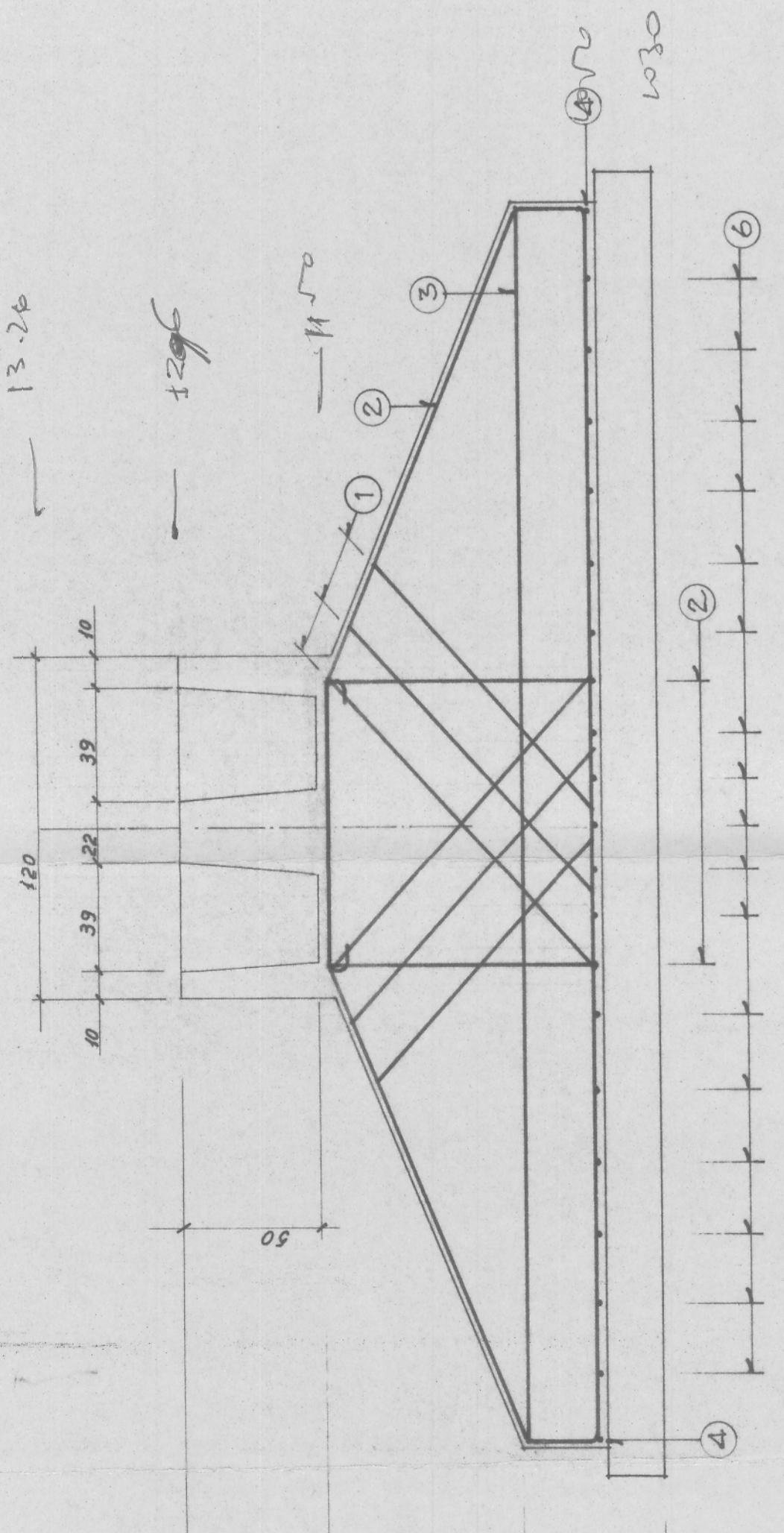
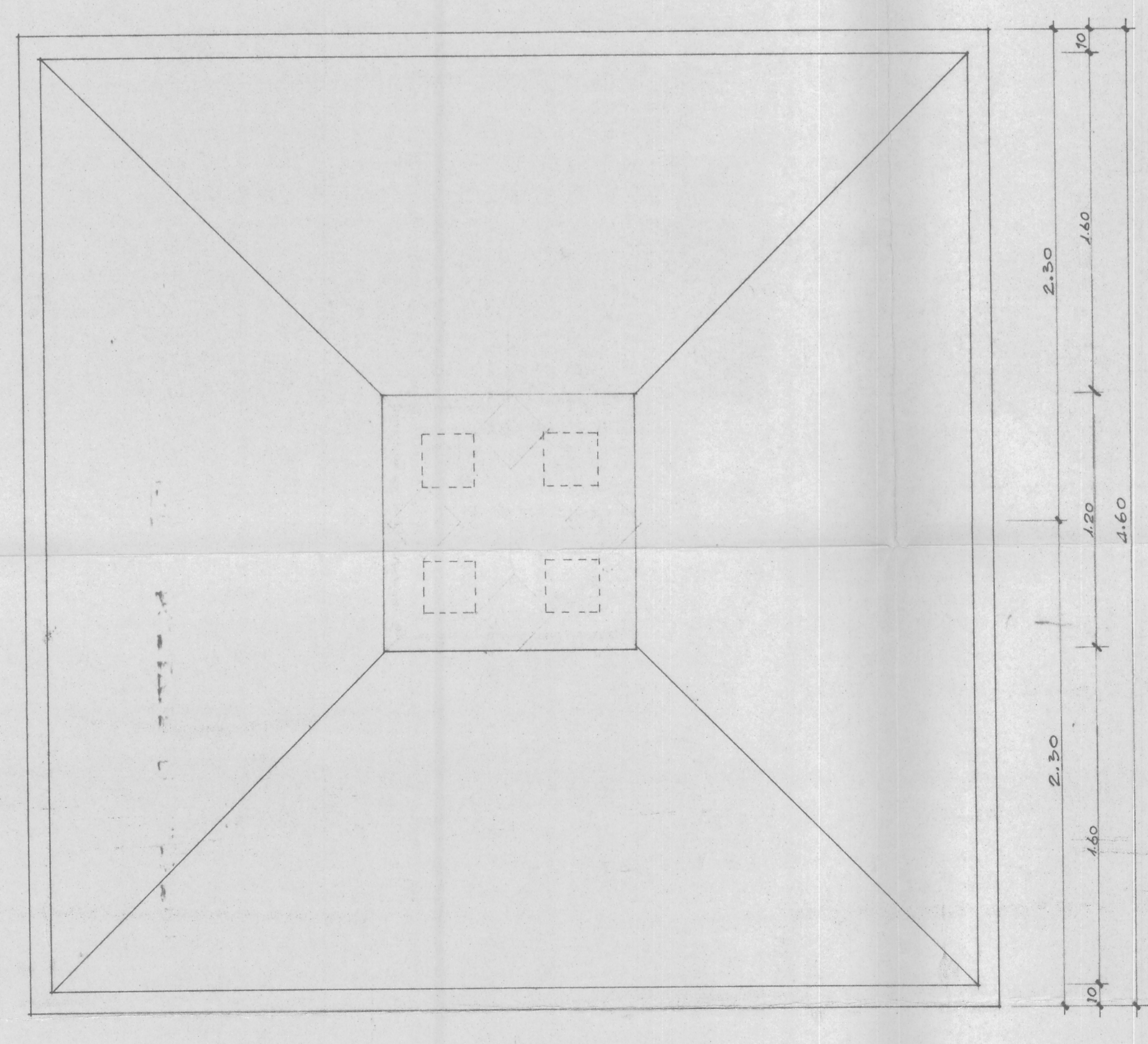

SEZIONE A-A'

questo disegno è stato
approvato in data 2/2/66.
autenticare le pitture

ufficio tecnico impresa Ing. Pio Guaraldo

ARMATURA DEI PLINTI
N° 215

PROGETTO DEL FORO BOARIO
DI PADOVA

200

1:20

strada castellana
pass. in. (tel. 9315)
Ing. Aldo Rampazzo
n. 25/8-1966